

Dune Villa

6 BEDROOM 6.5 BATHROOM

First floor

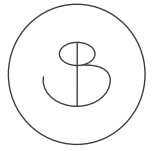

SOUTH BANK
TURKS & CAICOS



TOTAL COVERED AREA	2,244 SQ.FT
TOTAL EXTERNAL AREAS	778 SQ.FT
TOTAL AREA	3,022 SQ.FT



The content of this brochure does not form part of any contract, nor does any part constitute a representation or a warranty. The plans and renderings illustrated depict the overall style of the development and have been prepared for illustrative purposes and are indicative only. The plans are not drawn to scale. The exact dimensions of each lot will vary and shall be confirmed prior to legal transfer of the title to the plot. The plans and renderings depict the intended layout and design at the time of creating this document, however the developer reserves the right to make changes to the layouts shown at the sole discretion of the developer.

Dune Villa

6 BEDROOM 6.5 BATHROOM

Second floor

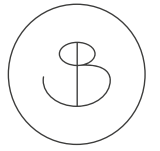

SOUTH BANK

TURKS & CAICOS



TOTAL COVERED AREA	3,285 SQ.FT
TOTAL EXTERNAL AREAS	2,321 SQ.FT
TOTAL AREA	5,606 SQ.FT



The content of this brochure does not form part of any contract, nor does any part constitute a representation or a warranty. The plans and renderings illustrated depict the overall style of the development and have been prepared for illustrative purposes and are indicative only. The plans are not drawn to scale. The exact dimensions of each lot will vary and shall be confirmed prior to legal transfer of the title to the plot. The plans and renderings depict the intended layout and design at the time of creating this document, however the developer reserves the right to make changes to the layouts shown at the sole discretion of the developer.

Dune Villa

6 BEDROOM 6.5 BATHROOM

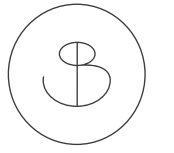

SOUTH BANK

TURKS & CAICOS

Third floor



TOTAL COVERED AREA	2,471 SQ.FT
TOTAL EXTERNAL AREAS	730 SQ.FT
TOTAL AREA	3,201 SQ.FT



The content of this brochure does not form part of any contract, nor does any part constitute a representation or a warranty. The plans and renderings illustrated depict the overall style of the development and have been prepared for illustrative purposes and are indicative only. The plans are not drawn to scale. The exact dimensions of each lot will vary and shall be confirmed prior to legal transfer of the title to the plot. The plans and renderings depict the intended layout and design at the time of creating this document, however the developer reserves the right to make changes to the layouts shown at the sole discretion of the developer.

Dune Villa

6 BEDROOM 6.5 BATHROOM

Roof

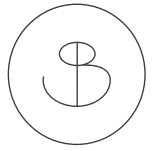

SOUTH BANK

TURKS & CAICOS



TOTAL COVERED AREA	171 SQ.FT
TOTAL EXTERNAL AREAS	1,169 SQ.FT
TOTAL AREA	1,340 SQ.FT



The content of this brochure does not form part of any contract, nor does any part constitute a representation or a warranty. The plans and renderings illustrated depict the overall style of the development and have been prepared for illustrative purposes and are indicative only. The plans are not drawn to scale. The exact dimensions of each lot will vary and shall be confirmed prior to legal transfer of the title to the plot. The plans and renderings depict the intended layout and design at the time of creating this document, however the developer reserves the right to make changes to the layouts shown at the sole discretion of the developer.

Dune Villa

6 BEDROOM 6.5 BATHROOM

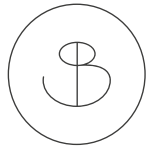

SOUTH BANK

TURKS & CAICOS

Lot Plan

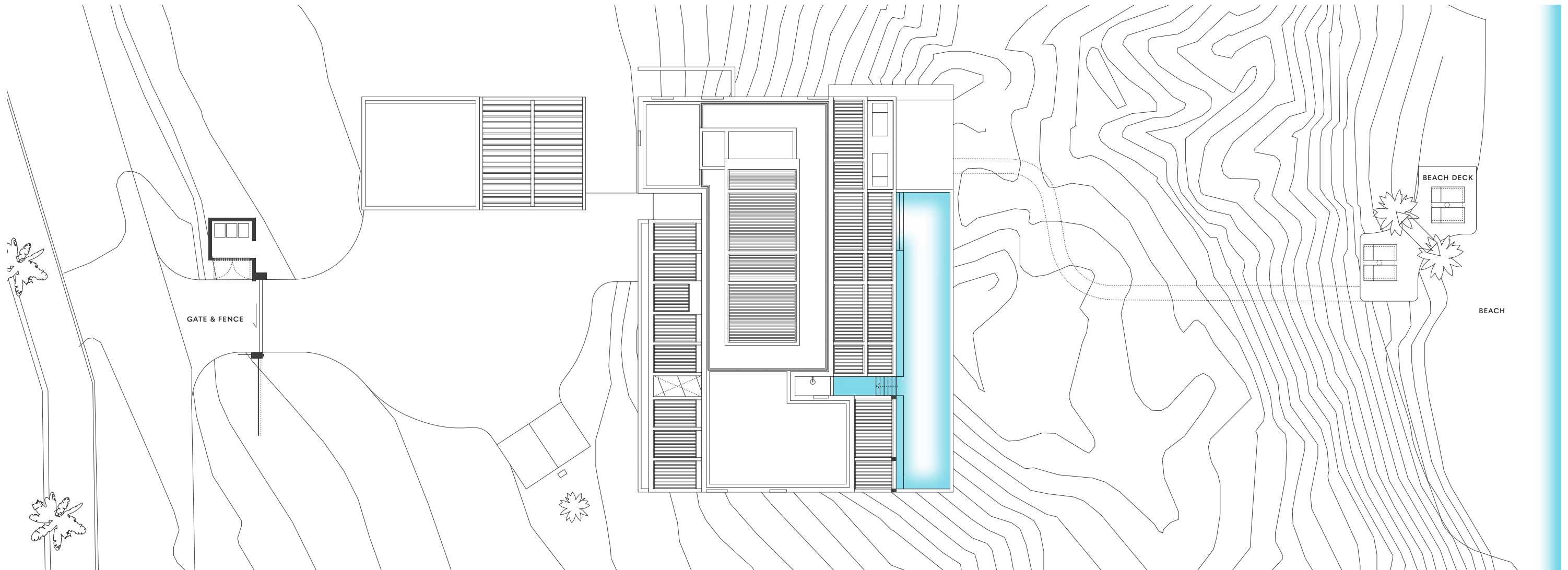

Specifications

LOT SIZES	0.7-0.77 AC
FRONTAGE	107 FT
TOTAL COVERED AREA	8,171 SQ.FT
TOTAL COVERED & EXTERNAL AREA	13,169 SQ.FT
BEDROOMS	6 (+staff)
BATHROOMS	6.5
POOL SIZE	61'6" x 11'2"



The content of this brochure does not form part of any contract, nor does any part constitute a representation or a warranty. The plans and renderings illustrated depict the overall style of the development and have been prepared for illustrative purposes and are indicative only. The plans are not drawn to scale. The exact dimensions of each lot will vary and shall be confirmed prior to legal transfer of the title to the plot. The plans and renderings depict the intended layout and design at the time of creating this document, however the developer reserves the right to make changes to the layouts shown at the sole discretion of the developer.